



THE CLASH OF HISTORY AND MODERN AGE

DISCOVER HOTEL ZOO  
BERLIN

## CONTENTS

Hotel Zoo	Page 3
Rooms and Suites	Page 4
GRACE Bar	Page 8
GRACE Restaurant	Page 9
ROOFTOP	Page 10
Conference Rooms	Page 11
Location	Page 12



## HOTEL ZOO BERLIN

An old gem is polished. Hotel Zoo, the jewel of Berlin's Kurfürstendamm from the 1920s to the 1950s, shines brightly once again. Designer Dayna Lee has reinvented the hotel while keeping its history and character. With thoughtful attention to detail and the preservation of original building elements, Lee infused the space with New York flair and London townhouse elegance.

Dayna Lee has embraced the building's past historical glory with the new design. Built in 1891 as a private residence, the building was converted to an upscale hotel in 1911. In the 1950s it was the VIP hotel of the Berlin International Film Festival, accommodating many celebrities of that time. High ceilings, bespoke furniture and Dayna Lee interior design give the spacious rooms and suites their unique charm

The heart of the hotel is the Living Room, with its seven-meter-high ceiling crowned by a handmade stucco ceiling, an oversized old wood door and shaped with a high industrial windows. A five-meters-long open fireplace gives the room a warm atmosphere while the over 120 years old brick walls exposes the building past.



## ROOMS AND SUITES

At the new HOTEL ZOO BERLIN, blending historical authenticity with sleek modernity was paramount. Designer Dayna Lee treated the rooms and their bespoke layouts individually, with an intended pied à-terre impression resulting. Careful preservation of the unique trademarks that the over a century old building provided was meticulously executed. Room characteristics range from the classic, with original brickwork and high ceilings, to the cutting-edge glass and curved lines of the new additions – both styles cohesively melding under one roof.

Views of the iconic Berlin skyline set the scene for urban explorations, with the bustling Kurfuerstendamm boulevard below. To strike the right balance of townhouse comfort and refined elegance, Lee assembled a peaceful palette of taupe, lilac, and eggshell for the varied guestrooms. Harmonious contrasts are created by custom-made walnut wood cabinetry and rich hardwood floors, offset by cream and light grey area rugs.

Specially crafted furniture is mixed with oyster-hued armchairs and matching buttonback headboards, while ivory-colored lampshades either hang or stand bedside. Plum, pumpkin, and moss green curtains provide strong color accents, and are also seen in the spacious bathroom designs. The walls of the bathrooms have been treated with textured woven wallpaper, the unique detailing adding subtle interest to the cool, neutral color scheme and slate grey tiling.



## SUPERIOR ROOM

20-31 sqm with King, Queen or Twin beds, views of either Kurfuerstendamm, the interior courtyard with ivy-covered giraffes and elephants or to the Theater des Westens. Bathroom with rain shower or bathtub and underfloor heating. Heat and soundproofed windows, adjustable air-conditioning, high speed internet access, Wi-Fi, LCD Flat Screen TV, Nespresso coffee machine, minibar, safe, desk, bathrobes and slippers by Maison Martin Margiela as well as bath products by April Aromatics.

## PANORAMA ROOM

22 sqm with Twin or Queen bed, floor-to-ceiling windows flooding the entire width of the room flood the room with light and offering uninterrupted views across Berlin's rooftops to either the Theater des Westens or Kurfuerstendamm (these also have a small balcony). Bathrooms with a rain shower or bathtub and underfloor heating. Heat and soundproofed windows, adjustable air conditioning and heating, high speed internet access, Wi-Fi, LCD Flat Screen TV, Nespresso coffee machine, minibar, safe, desk, bathrobe and slippers by Maison Martin Margiela and bath products by April Aromatics.

## DELUXE ROOM

25-31 sqm with a King or Queen bed, views of either Kurfuerstendamm, the interior courtyard with ivy-covered giraffes and elephants, or to the Theater des Westens, rain shower, bathtub (some are freestanding), bathroom with underfloor heating, heat and soundproofed windows, adjustable air conditioning and heating, high speed internet access, Wi-Fi, LCD Flat Screen TV, Nespresso coffee machine, minibar, safe, desk, bathrobe and slippers by Maison Martin Margiela and bath products by April Aromatics



## GRAND DELUXE ROOM

34-40 sqm with King bed, views of either Kurfuerstendamm, the interior courtyard with ivy-covered giraffes and elephants. Bathroom with rain shower or bathtub and underfloor heating. Heat and soundproofed windows, adjustable air-conditioning, high speed internet access, Wi-Fi, LCD Flat Screen TV, Nespresso coffee machine, minibar, safe, desk, bathrobes and slippers by Maison Martin Margiela as well as bath products by April Aromatics.

## JUNIOR SUITE

34-43 sqm with King or large platform bed, views of the interior courtyard with ivy-covered giraffes and elephants. A separate seating area and bathroom with rain shower or bathtub and underfloor heating. Heat and soundproofed windows, adjustable air-conditioning, high speed internet access, Wi-Fi, LCD Flat Screen TV, Nespresso coffee machine, minibar, safe, desk, bathrobes and slippers by Maison Martin Margiela, as well as bath products by April Aromatics

## KING SUITE

44-46 sqm with King or large platform bed, views of either Kurfuerstendamm or the interior courtyard with ivy-covered giraffes and elephants. Bathroom with rain shower and/or freestanding bathtub and underfloor heating. Elegant furnishings including a separate seating area. Heat and soundproofed windows, adjustable air-conditioning, high speed internet access, Wi-Fi, LCD Flat Screen TV, Nespresso coffee machine, minibar, safe, desk, bathrobes and slippers by Maison Martin Margiela, as well as bath products by April Aromatics.



## KU'DAMM SUITE

70 sqm with large platform bed, views of Kurfuerstendamm. Bathroom with rain shower, underfloor heating and a freestanding bathtub integrated into the room's design. Armchairs and sofa by George Smith as well as a fireplace which can be enjoyed from the bathtub and the living area. There are two access points to the balcony above. Heat and soundproofed windows, adjustable air-conditioning, high speed internet access, Wi-Fi, LCD Flat Screen TV, Turntable, Nespresso coffee machine, minibar, safe, desk, bathrobes and slippers by Maison Martin Margiela, uslu airlines airbrush kit, as well as bath products by April Aromatics.

## SUITE

105 sqm with living room, Bedroom with a King Size bed, dressing room, two bathrooms with dual rain showers and a freestanding bathtub with fireplace, powder room. Views to the interior courtyard with ivy-covered giraffes and elephants. Floor-to-ceiling windows flood the entire room with light. The room disposes from a double-sided fireplace that can be enjoyed from the living room and the bathtub.

Equipped with heat and soundproofed windows, adjustable air-conditioning, underfloor heating, high speed internet access, Wi-Fi, LCD Flat Screen TV, Turntable, Nespresso coffee machine and tea station, minibar, safe, desk, bathrobes and slippers by Maison Martin Margiela, uslu airlines airbrush kit, as well as bath products by April Aromatics.



## GRACE BAR

The GRACE Bar, the epicenter of the HOTEL ZOO BERLIN, located on the glamorous Kurfuerstendamm 25, advanced to become one of the most popular places in the "City West". As sexy as it gets - the bar represents elegance, whilst maintaining a modern touch of comfort. Dayna Lee created a perfect balance between emotion, proportion and appearance. It's not a coincidence, that the bar feels like an inviting movie set; a result of Dayna's extensive former experience in the Hollywood movie industry.

The vibrant atmosphere of the GRACE Bar successfully revives the roaring 20ies, where todays Gatsbys mingle and celebrate, sipping on champagne and extravagant cocktails. The hottest DJs and DJanes heat up the atmosphere even more on the weekends, creating the perfect setting for finest club atmosphere. Aside perfectly mixed all time classics, the menu boasts exotic cocktails with tonka bean, lemon grass, Szechuan pepper and ginger, giving the drinks a whim of sophistication and a perfect Asian touch.

Smoker come together on the adjoining open-air winter garden that attracts guests with its blazing 15-foot-long glass protected fireplace. One can definitely not leave the GRACE Bar without having indulged in a Liquid Cocaine, Shades of Grey or a Cosmopolitan Chaos to complete a perfect evening. Guests can visit the in-house GRACE Bar until 19:00. After that time it is frequently used for private events and may not be accessible





## GRACE RESTAURANT

GRACE, what lies behind this alluring name is the new glamorous restaurant in Berlin's city west that advanced to an in-spot for casual fine dining shortly after its opening in early 2015. The cosmopolitan charisma of the interior design paired with the enchanting menu result in an exceptional culinary experience. The young and fierce kitchen team soaks up the nonchalant lifestyle from the restaurant and conveys it onto the menu. Heading towards a new, uncharted culinary territory, the chefs create exclusive dishes, not to be found anywhere else.

The cuisine paired with the ambience of the restaurant, leave you breathless. Every dish can be served as a party friendly small plate, making the dining experience a social event. The service staff completes this concept, ensuring the guest an unforgettable evening. Creamy Rock Shrimps, Beef Summer Roll, Asia burrata, there is such a wide array of tasty delights on the starter menu, it is best to load up on them all, staying true to the small plate principle of sharing and enjoying.

Mains include the Miso Black Cod and the Maine Lobster with yuzu or, for the beef lovers, the Filet Chinois with pak choi and cocoa bean and the Rib Eye Steak with green asparagus and lavender. Vegetarian dishes like the Braised Eggplant and Jaipur Artichoke are worth ordering anytime. The dessert menu is studded with delicious delights including the New York Cheesecake and the Pecan Chocolate Cake. The wine menu provides a wide selection to perfect the evening. If the weather permits, the dinner can be enjoyed on the lush green terrace of the restaurant.



## ROOFTOP BAR

One of the city's most spectacular rooftop terraces, the cherry on top of the HOTEL ZOO BERLIN. This oasis of peace is another stroke of genius from American interior designer. Dayna Lee, signing the entire premise with her urban townhouse style. The new rooftop terrace is a stunning space, completing the hotel's portfolio of glamorous venues.

The rooftop provides a bar and a lounge area accommodating up to 100 guests. The view from the terrace boast a stunning 270-degree panorama of the Berlin cityscape with the southwest exposure allowing spectacular sunsets views. An open fireplace and a waterfall dancing under a vegetated rim complete the settings, creating a parallel universe away from the buzz of the city.

Guests can relax on beautiful teakwood loungers and enjoy a drink while facing the breathtaking sight. BBQs are organized upon request to enjoy a great dinner on top of Berlin. On special events, the terrace hosts top-notch DJs enhancing the atmosphere with relaxing clubhouse tunes.



## CONFERENCE ROOMS

The 200 sqm conference and event space features floor to ceiling windows all around and a view to the Neue Kranzler Eck shopping complex. The flexible conference space can be divided into four separate rooms and is equipped with the latest technology in terms of equipment. A separate area is perfectly suited for receptions, coffee breaks and other events. This area also offers access to balconies around the meeting space. Lunch can be arranged at GRACE Restaurant.

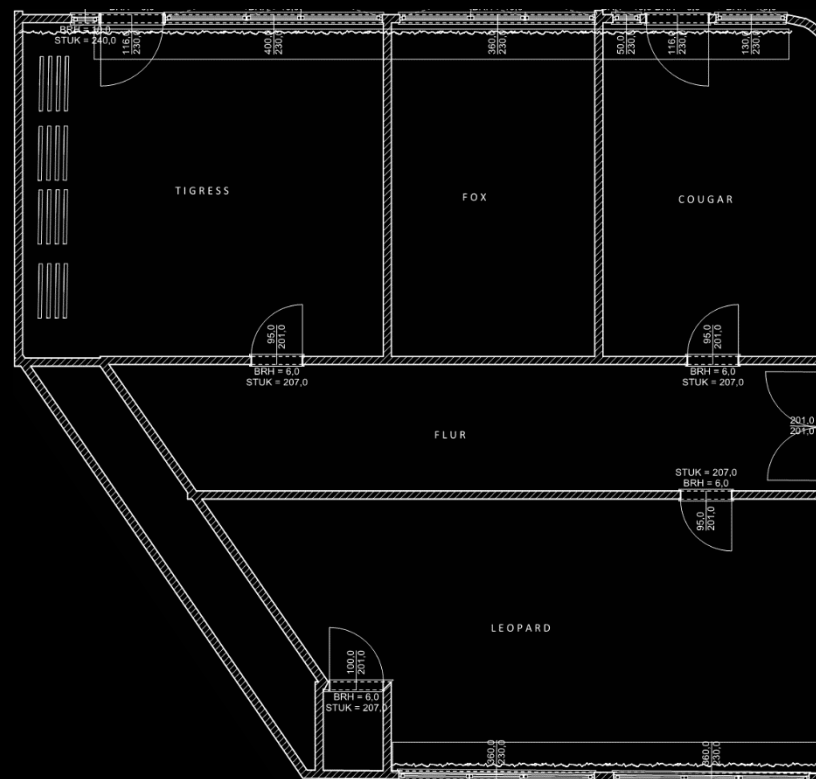



## LOCATION

Great cities are defined by their grandest boulevards. Hotel Zoo is ideally located on the prestigious Kurfuerstendamm (Ku'damm in Berlin's City West. The boulevard boasts a bevy of luxury boutiques, apartments and premium automobile showrooms as well as many galleries, bars and restaurants. In the 1920s, the boulevard (which dates back to the mid 16th century) was renowned as a magnet for intellectuals and bohemians who would frequent its many jazz bars, theaters and cabarets.

The hotel is ideally situated for exploring the historic and cultural attractions of City West. These include Kaiser Wilhelm Memorial Church, the restored theater Schaubuehne am Lehniner Platz and Emil Schaudt's KaDeWe department store – everything is accessible walking distance.



HOTEL ZOO BERLIN

Kurfuerstendamm 25

10719 Berlin

Phone: +49 30 88437 0

[res@hotelzoo.de](mailto:res@hotelzoo.de)

[www.hotelzoo.de](http://www.hotelzoo.de)